

DRAWING NO.	MATERIAL:	ORIGIN:
S-604-1	LCP E4008	DG

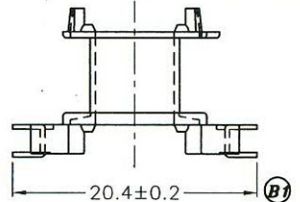

B-089.101L

B-089.102L

REV.	REVISIONS REC.	REV.	REVISIONS REC.
1	CANCEL (B2),(P),(S); ADD (I),(C2); UPDATE DRAWING.		
г. Санкт-Петербург, ул. Свободы, 50 +7(812) 407-25-20			

DRAWN & DRAFTED BY ZHANG ZHI QIANG	TOLERANCES		ANGLE: $\pm 1^\circ$	TITLE: C TYPE SMD BOBBIN RM-6
	0<L≤4 ±0.1	COPLANARITY 0.1 MAX	UNIT: MM	BOBBIN MATERIAL: LCP E4008
CHECKED & APPROVED BY JOHN RONG	4<L≤16 ±0.2		ORIGIN: DG	UL REC. UL 94V-0
	16<L≤63 ±0.3		PIN MATERIAL: PHOSPHOR BRONZE	PIN TENSION LOAD: 1.0KG MIN
PIN SHINE INDUSTRIAL CO., LTD. TEL:886-2-22990545 FAX:886-2-22990546		DATE: APR.02 '2003	DRAWING NO. S-604	REV. 1